

MG Series



MG Series Grinder

The **MG SERIES GRINDER** Tsurumi submersible pumps are designed for handling raw sewage, heavy duty industrial and food processing applications, where the pump is required to operate continuously while grinding oversized materials. With the unique high chrome grinder impeller and shredder plate design in the **MG SERIES GRINDER** pumps, Tsurumi has the right model to handle every application to efficiently transfer the most aggressive solid laden liquids, in the pump market. Available in 2, 3 & 5HP in Free-standing & Guide Rail designs.

Performance Curves

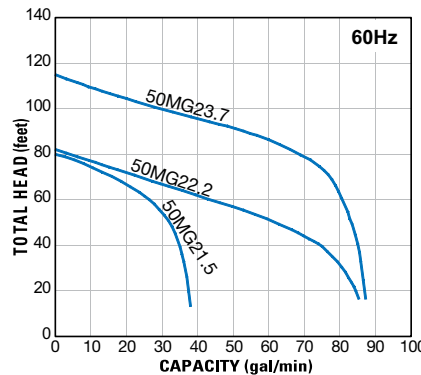

Dimension: Free Standing

Dimension: Guide Rail Fitting (TOS)

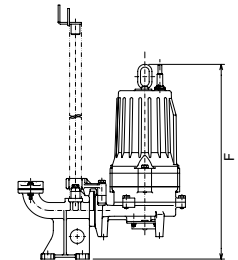
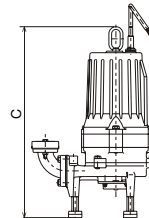
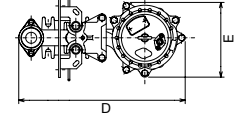
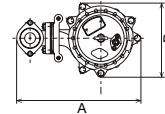

* Synchronous Speed

Specifications

| Three Phase Model | Motor Output (HP) | Rated Current (A) | | | | *S.S. (RPM) | Discharge Size (in.) | Dimensions (in.) | | | | | | Max. Solids Dia. (in.) |
|-------------------|-------------------|-------------------|------|------|------|-------------|----------------------|----------------------|--------|----------|-----------------------|--------|----------|------------------------|
| | | 208V | 230V | 460V | 575V | | | Free Standing Models | | | TOS Guide Rail Models | | | |
| | | | | | | | | A | B | C | D | E | F | |
| (TOS)50MG21.5 | 2 | 6.7 | 6.6 | 3.3 | 2.6 | 3600 | 2 | 14 5/16 | 8 9/16 | 21 15/16 | 24 7/16 | 8 9/16 | 23 1/8 | 0.197 |
| (TOS)50MG22.2 | 3 | 10.0 | 9.8 | 4.9 | 3.8 | 3600 | 2 | 17 1/4 | 8 7/8 | 23 3/8 | 24 7/16 | 8 7/8 | 24 11/16 | 0.197 |
| (TOS)50MG23.7 | 5 | 14.4 | 13.6 | 6.8 | 5.3 | 3600 | 2 | 17 1/4 | 8 7/8 | 23 3/8 | 24 7/16 | 8 7/8 | 24 11/16 | 0.197 |

COMPACT & LIGHTWEIGHT STAINLESS STEEL PUMPS

SQ Series

TSURUMI **SQ Series** Stainless Steel Pumps are rust-free and corrosive resistant.



- All components including motor frame are made of SS 304 Stainless Steel
- White mineral oil is used as the lubricant
- The flow-through design and heat resistant Silicon Carbide Mechanical Seals assist in cooling in the event of run-dry situations
- Semi-vortex, stainless steel impeller with replaceable / adjustable wear plate increases wear resistance when pumpage contains abrasive particles

Performance Curves

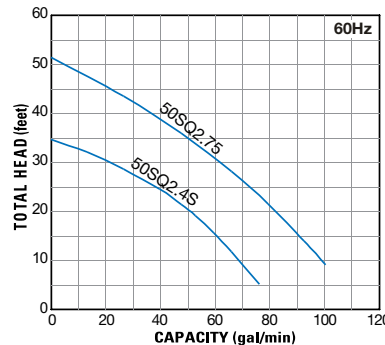

Dimension: Free Standing

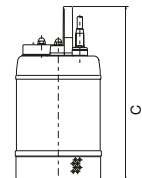
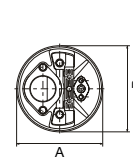

Specifications

* Synchronous Speed

| Single Phase Model | Motor Output (HP) | Rated Current (A) | | | | *S.S. (RPM) | Discharge Size (in.) | Dimensions (in.) | | | Max. Solids Dia. (in.) |
|--------------------|-------------------|-------------------|------|----------------------|------|-------------|----------------------|----------------------|--------|--------|------------------------|
| | | 115V | 230V | Free Standing Models | | | | | | | |
| | | | | A | B | | | C | | | |
| 50SQ2.4S | 1/2 | 6.5 | 3.4 | 3600 | 2 | 7 1/16 | 7 1/16 | 14 5/16 | 0.236 | | |
| Three Phase Model | Motor Output (HP) | Rated Current (A) | | | | *S.S. (RPM) | Discharge Size (in.) | Dimensions (in.) | | | Max. Solids Dia. (in.) |
| | | 208V | 220V | 460V | 575V | | | Free Standing Models | | | |
| | | | | | | | | A | B | C | |
| 50SQ2.75 | 1 | 3.5 | 3.4 | 1.6 | 1.3 | 3600 | 2 | 7 1/16 | 7 1/16 | 15 1/8 | 0.236 |